



Assembly Instructions Infeed and Outfeed Tables (Stock No. 98-2201)

For use with Sander models ShopPro 25, 22-44 Pro, and Pro Max

*NOTE: Sander should be bolted to a stand or work table when using the infeed and outfeed tables.
Maximum working load of a table is 35 pounds.*

Remove the items from the packaging and inspect all parts.

Tools required: 1/2", 7/16", 9/16" wrenches

Refer to Figure 1.

1. If table rails are already bolted to the power feed conveyor, remove two of the 5/16"x3/4" hex head bolts (3) and square nuts (4) from the infeed (gear motor end) of the conveyor. **Note:** Table rails were included with your conveyor table and are not part of Infeed/Outfeed table assembly. You may have to open the controller box to remove the hex head bolt and square nut next to the gearmotor.
2. Slide mounting brackets (2L,2R) into end of table rails on infeed side. Align holes and install using 5/16"x3/4" hex head bolts (3), square nuts (4) and 3/8" hex bolts (7), washers (8) and nuts (9). Tighten 5/16" hex head bolts (3) first to align support brackets (2L,2R), then tighten 3/8" hex bolts (7).
3. Install the table (1) to the mounting brackets (2L,2R) using four 1/4"x3/4" square neck bolts (10), 1/4" washers (12), and 1/4" nuts (11). Finger tighten. Note: Some sander models may require the extra 1/4" washers to be placed between the table (1) and mounting brackets (2L,2R) to remove extra space between the table and brackets.
4. Position the tables level with or slightly below the conveyor table for proper support of stock. To check position, place a level or straight edge on left side of the conveyor bed under the sanding drum (see Figure 2). Extend the level out over the table. Raise the conveyor bed to securely hold the level

or straight edge in place. Raise the table until it is even with or slightly below the conveyor bed. Tighten the 1/4" hex nuts (11). Repeat this procedure for right side of table.

5. Repeat the previous steps for mounting the Outfeed Table to the back, or outfeed, side of sander.

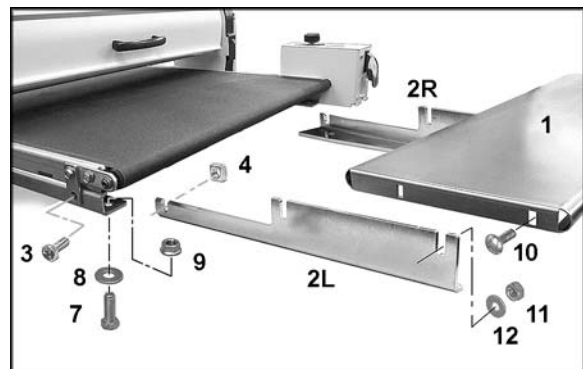

Figure 1

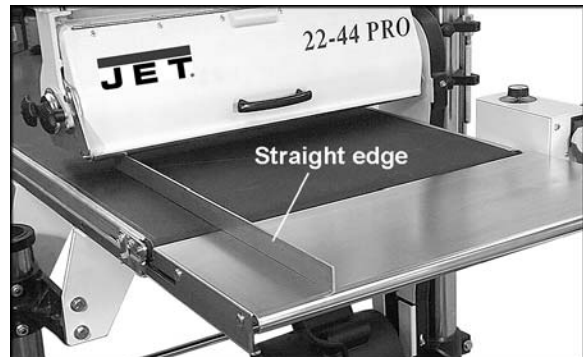

Figure 2

Troubleshooting

If the stock being sanded is bowed, warped or otherwise inconsistent, be sure tables are lower than the conveyor surface.

If stock slips on conveyor belt, the tables may be positioned too high. Lower tables to allow stock to remain in contact with the conveyor belt.

Parts List

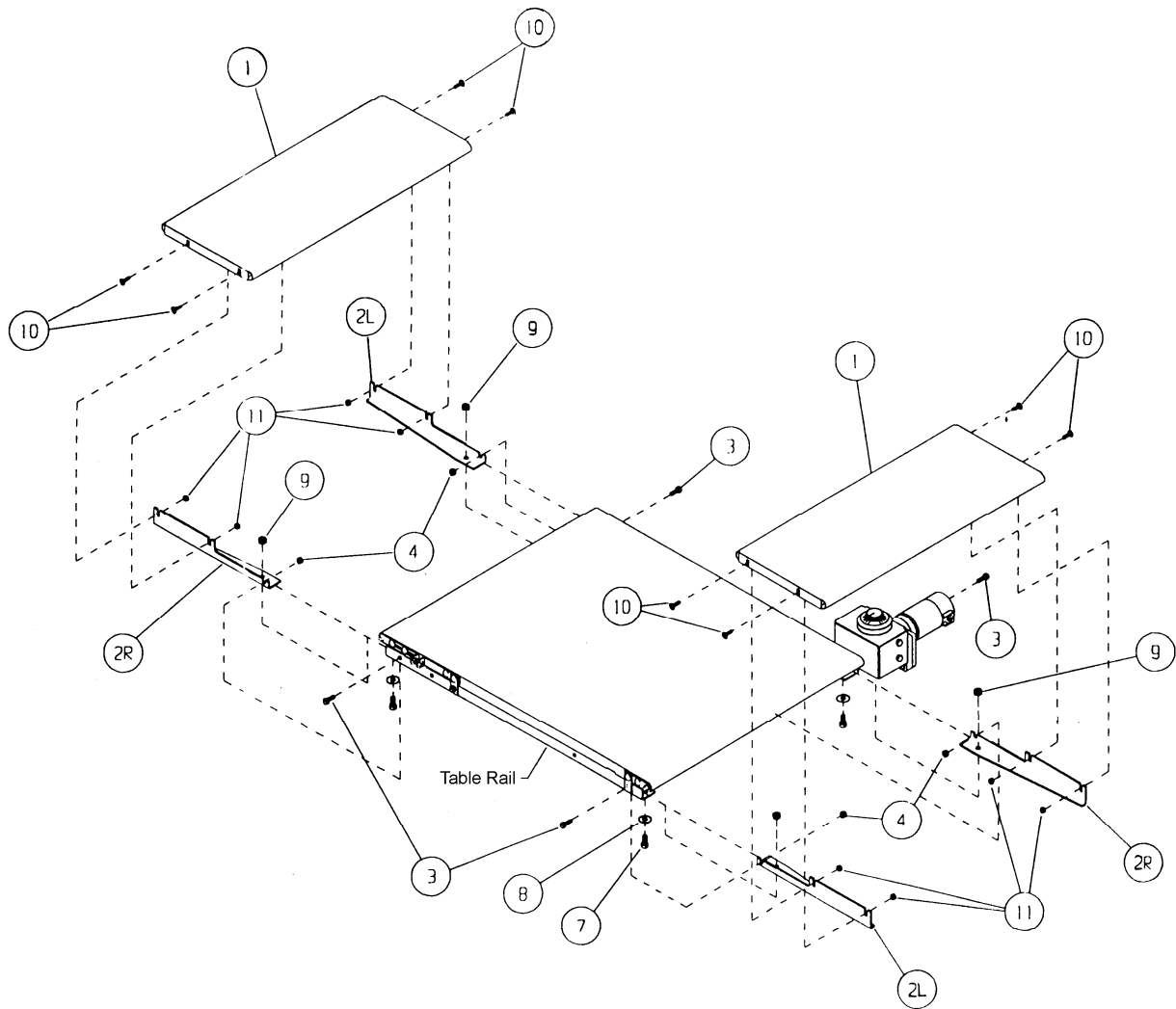

Index No.	Part No.	Description	Size	Qty
1.....	40-0329	Infeed/Outfeed Table		2
2L.....	40-0327	Mounting Bracket (LH)		2
2R.....	40-0328	Mounting Bracket (RH)		2
3.....	10-9103	Hex Head Bolt	5/16"-18x3/4"	2
4.....	12-0152	Square Nut	5/16"-18	2
7.....	10-9205	Hex Head Bolt	3/8"-16x1"	4
8.....	11-9103	Hardened Flat Washer	3/8"	4
9.....	12-0209	Flanged Lock Nut	3/8"-16	4
10.....	6714264	Round Head Square Neck Bolt	1/4"-20x3/4"	8
11.....	6514001	Hex Nut	1/4"-20	8
12.....	6861107	Flat Washer	1/4"	16